

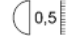

ALMA

last update 15/06/2010

TER1011

Alma: code C777.GU.__ max.2X50W QPAR16/GU-GZ10 or 2x7W Fluo Compact/GU10 or 2x LED 5W GU10 - 230V~ - CE - IP65 -  -  - 
code C777.EC.__ max.2X50W QPAR16/GU-GZ10 or 2x14W Fluo Compact/GU10 or 2x LED 7W GU10 - 230V~ - CE - IP65 -  -  - 

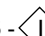
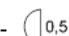
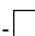
TerZoLight

BEL LIGHTING sprl
Avenue Ernest Solvay 42
B-1480 Saintes (Tubize)
Belgium
Phone: +32(0)2 3552428
Fax: +32(0)2 3550396
e-mail: info@bel-lighting.com
www.bel-lighting.com

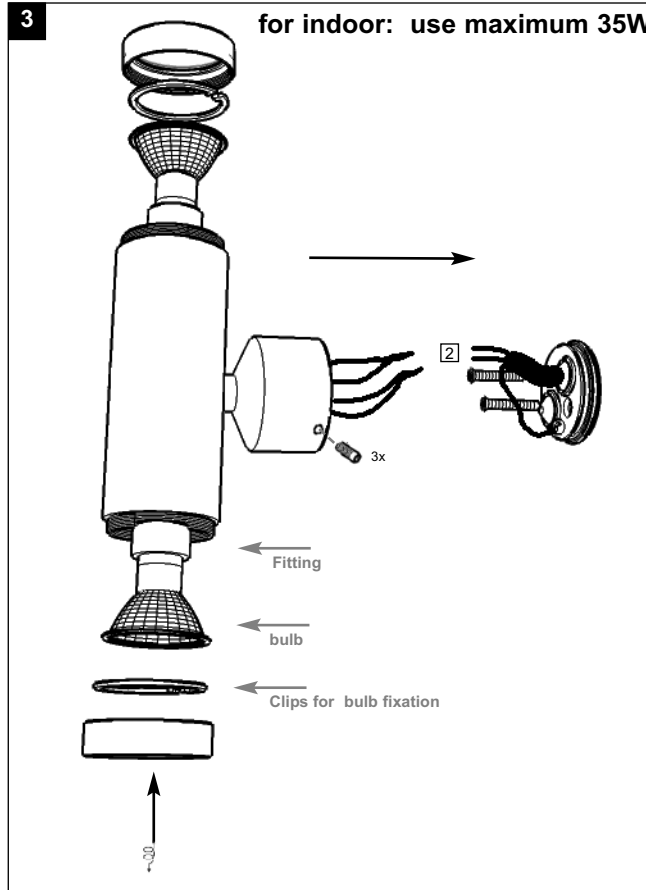
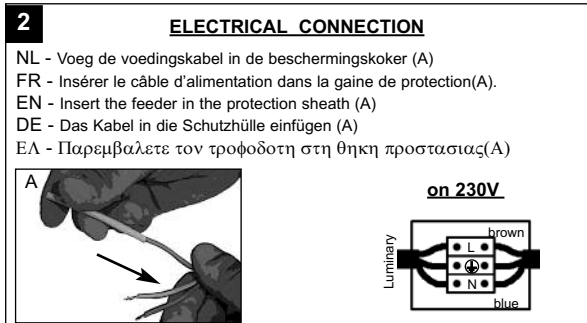
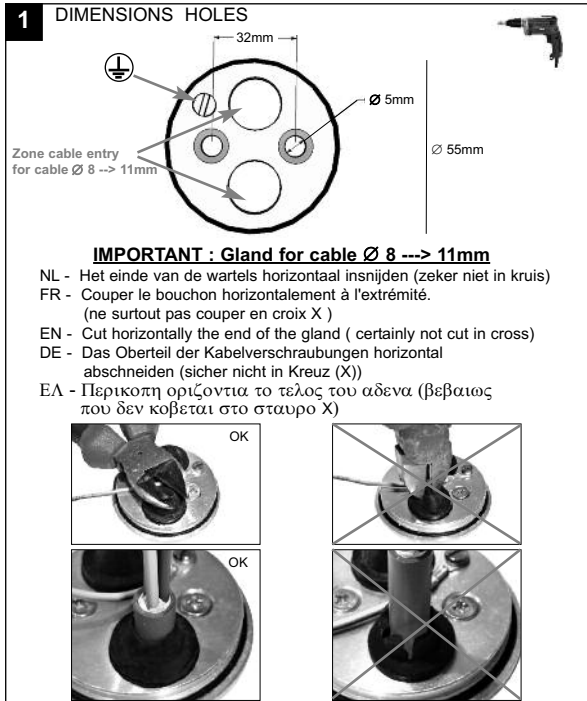

INSTALLATION INSTRUCTIONS - PART A

1. FIT THE WALL FIXATION ON THE WALL
2. MAKE THE ELECTRICAL CONNECTION
3. PLACE THE LUMINARY
4. SWITCH ON

ACCESSORY SET (B)

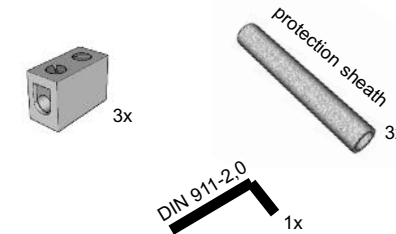

belpasta 1g

NL Voor een correcte installatie is het verplicht de schroeven te behandelen met belpasta.
FR Pour une bonne installation, vous devez enduire les parties à visser avec la graisse belpasta ci-jointe.
EN For a good installv, it is obliged to put the grease belpasta on the screwing part .
DE Sie müssen die Teile der Leuchte, die geschraubt werden mit dem beigefügten Fett belpasta bestreichen.
GR Για καλυ εγκατασταση, σας συνιστούμε να βαλετε στα σημεια προς βιδωμα λιγο γρασο belpasta, το οποιο βρισκεται στην συσκευασια.

PART A

Lees de algemene gebruiksvoorwaarden : PART B
Lire attentivement les conditions generales d'utilisation: PART B
Read attentively the general instructions: PART B
Lesen Sie die algemeinen Gebrauchsanweisungen: PART B
Διαβάστε τις γενικες οδηγίες : PART B

WAARSCHUWING
AVERTISSEMENT
WARNING
WARNUNG
ΠΡΟΣΟΧΗ